

Plafoniera industriale IP66 ATEX BC5401 LED

VoltNextT



Ex marking: Ex de op is IIC T5 Gb
Ex op is tb IIIC T95°C Db, IP66



Application

- It can be widely used in petrochemical plants, oil platforms, oil pump housing, transit stations and other flammable and explosive places as fixed lighting.
- Gas explosive environment: Group IIA, IIB, IIC.
- Zone1, Zone2; Zone21, Zone22

Characteristics

- It is made using a special aluminum housing, suitable for long-term highly corrosive environment of offshore platforms, chlor-alkali, hydrogen sulfide, etc.
- Derrick mounting fixture adopt high anti-corrosive aluminum and locking angle equipment, can be safely used in drilling platforms and high vibration environment.
- The anti corrosion, abrasion proof, power coated cover which is dust proof, water proof, make the lamp an excellent high pressure environment
- Bracket, reflector, guard, and all exposed fasteners adopt 304 stainless steel (customizable 316), can effectively guarantee the strength and strong anti-corrosion performance of lamp
- Terminals are provided at both ends, can be directly wired in parallel, eliminating the junction box and installation costs.
- A variety of installation as optional: ceiling, oil derrick, the side walls, curved rods, boom, etc.

Light distribution curve

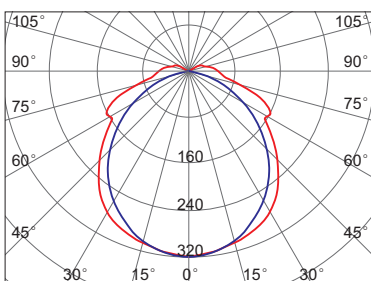
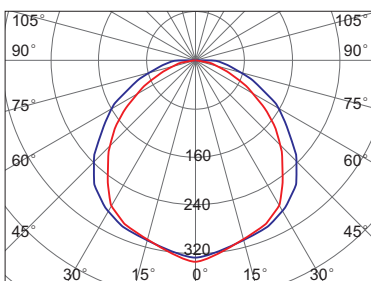

Main Specification

| Item | Technical Parameters | | | |
|--------------------|---|-----------------|--------------------|-----------------|
| Rated wattage (W) | 2 × 20W (T8) | 2 × 10W (T8) | 2 × 28W (T5) | 2 × 14W (T5) |
| Input voltage (V) | 90~264VAC | | 220~240VAC, 110VAC | |
| Rated frequency | 50Hz / 60Hz | | 50Hz / 60Hz | |
| Light source | LED | | Fluorescent | |
| Light output (lm) | 3600 | 1800 | 3400 | 1700 |
| CRI (Ra) | 80 | | 70 | |
| Life time (h) | 50,000 | | 8,000 | |
| CCT | 5000K | | 6500K | |
| Cable entry thread | M20×1.5, M25×1.5, NPT3/4", NPT1/2", G3/4" | | | |
| Terminals | Multi core: ≤2.5mm ² | | | |
| | Single core: ≤4mm ² | | | |
| Dimension (mm) | 1390 × 180 × 110 | 780 × 180 × 110 | 1390 × 180 × 110 | 780 × 180 × 110 |
| Net weight (kg) | 10.7 | 6.6 | 10.7 | 6.6 |

Plafoniera industriale IP66 ATEX BC5401 LED

VoltNext

Drawing of dimension (Dimensions in mm)

Ceiling mounting

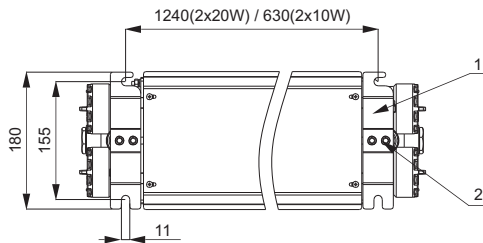
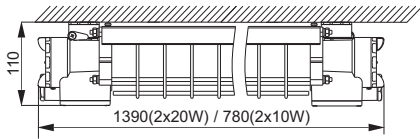

Lamps Ordering Information

| Order No. | Mounting type | Lamp power | Equivalent to |
|-------------|---------------|------------|---------------|
| | | | Fluorescent |
| BC5401-L20A | Ceiling | 2×10W | 2×20W |
| BC5401-L40A | | 2×20W | 2×40W |

Fitting Ordering Information (Standard)

| Order No. | No. | Specifications Model | Quantity |
|-----------|-----|-------------------------|----------|
| P01 | 1 | Ceiling Bracket | 2 |
| | 2 | M8 Inner six angle bolt | 4 |

Derrick mounting

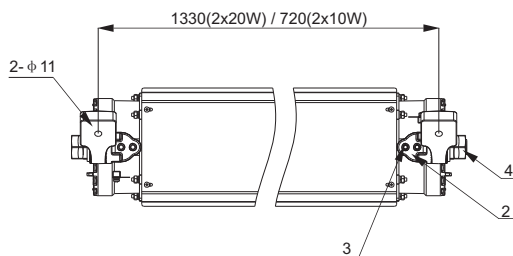
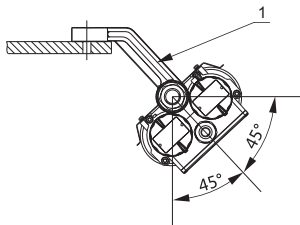

Lamps Ordering Information

| Order No. | Mounting type | Lamp power | Equivalent to |
|-------------|---------------|------------|---------------|
| | | | Fluorescent |
| BC5401-L20A | Derrick type | 2×10W | 2×20W |
| BC5401-L40A | | 2×20W | 2×40W |

Fitting Ordering Information(Optional)

| Order No. | No. | Specifications Model | Quantity |
|-----------|-----|-------------------------|----------|
| P02 | 1 | Derrick bracket | 2 |
| | 2 | Base | 2 |
| | 3 | M8 Inner six angle bolt | 4 |
| | 4 | M24 screw | 2 |

Plafoniera industriale IP66 ATEX BC5401 LED

VoltNexT

Side wall mounting

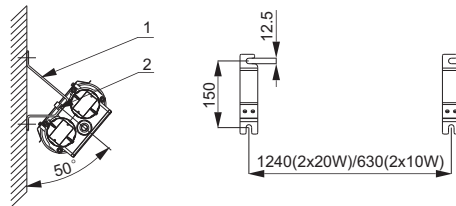

Lamps Ordering Information

| Order No. | Mounting type | Lamp power | Equivalent to |
|-------------|---------------|------------|---------------|
| | | | Fluorescent |
| BC5401-L20A | Side wall | 2×10W | 2×20W |
| BC5401-L40A | | 2×20W | 2×40W |

Fitting Ordering Information (Optional)

| Order No. | No. | Specifications Model | Quantity |
|-----------|-----|--------------------------|----------|
| P03 | 1 | Sidewall bracke | 2 |
| | 2 | M10 Inner six angle bolt | 4 |

Pole mounting

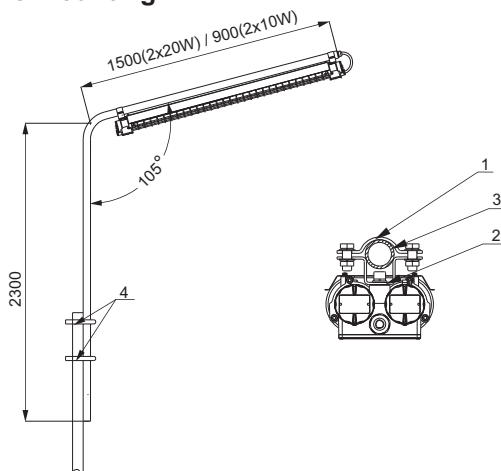

Lamps Ordering Information

| Order No. | Mounting type | Lamp power | Equivalent to |
|-------------|---------------|------------|---------------|
| | | | Fluorescent |
| BC5401-L20A | Pole | 2×10W | 2×20W |
| BC5401-L40A | | 2×20W | 2×40W |

Fitting Ordering Information (Optional)

| Order No. | No. | Specifications Model | Quantity |
|-----------|-----|----------------------|----------|
| P04 | 1 | Upper hoop | 2 |
| | 2 | Under hoop | 2 |
| | 3 | DN32 Poles | 1 |
| | 4 | U tube clip | 2 |

Ceiling mounting 2

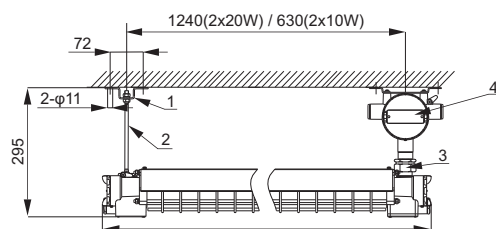

Lamps Ordering Information

| Order No. | Mounting type | Lamp power | Equivalent to |
|-------------|---------------|------------|---------------|
| | | | Fluorescent |
| BC5401-L20B | Ceiling | 2×10W | 2×20W |
| BC5401-L40B | | 2×20W | 2×40W |

Fitting Ordering Information (Optional)

| Order No. | No. | Specifications Model | Quantity |
|-----------|-----|------------------------------|----------|
| P05 | 1 | Pole mounting bracket | 1 |
| | 2 | 19cm Screw(M8) | 1 |
| P02 | 3 | Connector G3/4" male- male | 1 |
| BHD01 | 4 | Explosion proof junction box | 1 |